



# KSCI60 with Legs

## INSTALLATION INSTRUCTIONS

### Tools Needed

- Wrench • Pencil • Tape Measure • Plumbers Putty •

**Be sure to re-inforce wall before installation. We recommend a 2"x12" securely fastened to wall studs at desired height for your installation.**

### Cast Iron Wall Mount Sinks With & Without Legs

#### Steps:

- Make sure to have proper wood blocking to support weight of sink in the wall.
- Determine the optimal height
- Heavy leg bolts recommended (do not use dry wall screws)
- Mount the wall bracket to the desired position on the wall (See Image A)
- Sink brackets will be preinstalled to the back of sink.
- Attach sink brackets to wall brackets.
- See preinstalled leg mounts underneath sink. (See Image B)
- Place leg into position and slide bolt through leg mounts
- Be sure that legs are secured to bottom of the sink
- Bottom feet of legs screw in and out to make the sink level

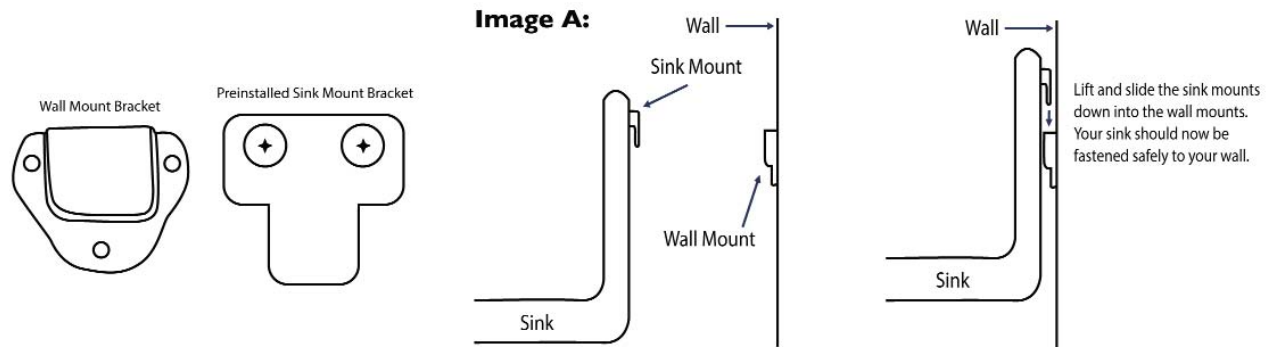

#### Image B:

